

The N6DHPACA Airewave™ is Tyler's most efficient vertical multi-deck merchandiser that combine Tyler's TC Coil and a dual-discharge air curtain system. These two patented technologies efficiently distribute cold air throughout the merchandiser's interior while providing a secondary ambient "air curtain" that keeps the cold air inside while reducing air spillage into the aisle.



Model N6DHPACLA shown

High Performance TC Coil™

High Performance (HP) Merchandisers feature our patented TC Coil™ design, which represents a major technology breakthrough for the commercial refrigeration industry. Developed jointly by Carrier Corporation and Tyler, the TC Coil™ enables HP merchandisers to operate more efficiently, providing energy savings that allow faster payback periods for food retailers.

Note: For more information about Tyler high performance display merchandisers featuring TC Coil™, go to the Technologies section of this catalog on page 8.

Features & Benefits

- Airewave™ secondary fan assembly.
- Energy-efficient copper tube and aluminum fin coils.
- Double row of energy-efficient T8 canopy lights.
- Hinged light channel allows easy access to ballasts.
- Solid steel base adds strength and durability.
- Easily removable interior components for quicker cleaning.
- Fan assembly design allows access to coil and drain pan.
- Off-cycle defrost.

Options

- ECM fan motors for additional energy savings.
- Energy-efficient T8 nose light or T8 shelf lighting with remote ballasts for greater product illumination.
- Multiple depth shelving alternatives.
- 3 or 6 position shelf brackets for varied shelf display angles.
- Front & side facia panels for Airewave secondary air system.
- Peg bar display systems.

Specifications are subject to engineering changes without notice.



**N6DHPACLA
N6DHPACMA
N6DHPACHA**

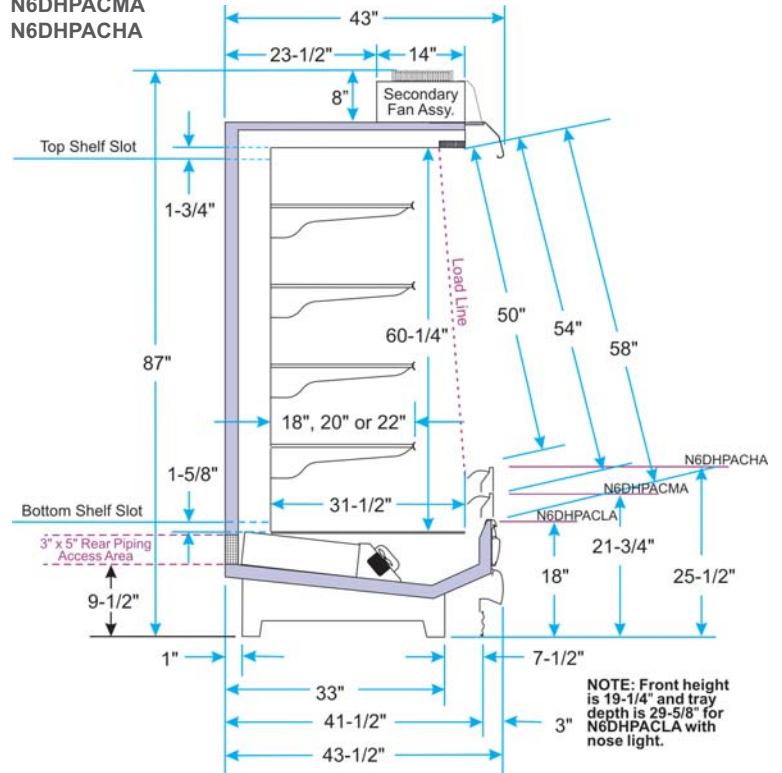

NOTE: Front height is 19-1/4" and tray depth is 29-5/8" for N6DHPACLA with nose light.

Model	Case Length	Description	Capacity in Cubic Feet*
N6DHPACLA	6' • 8' • 12'	18" Front, Multi-Deck, TC Coil with Airewave™	56.1 • 74.7 • 112.1
N6DHPACMA	6' • 8' • 12'	22" Front, Multi-Deck, TC Coil with Airewave™	56.1 • 74.7 • 112.1
N6DHPACHA	6' • 8' • 12'	26" Front, Multi-Deck, TC Coil with Airewave™	56.1 • 74.7 • 112.1

* Cubic capacity is based on four rows of 22" shelves.

ALLOW 3" SPACE between the back of this case and the store wall, other cases or coolers to minimize possible condensation problems. FORCED VENTILATION may be necessary in some situations.

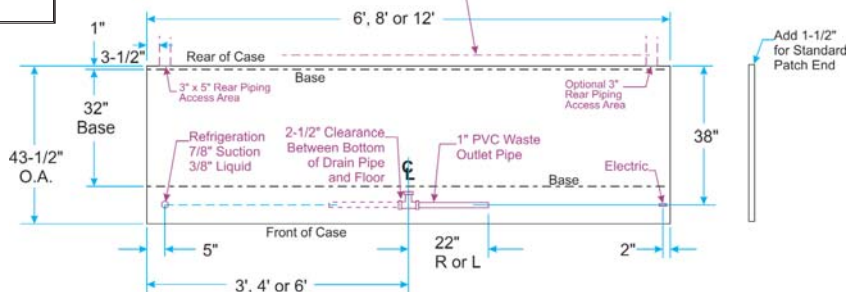

Optional Accessories



Energy efficient T8 nose lights provide additional illumination for products on lower shelves.